

My Construction Planner

MyConstructionPlanner.com

Instruction for "Dream Builder"

This tool lets you explore all kinds of room layouts before your room is even built. These pages reproduced here can easily and accurately be printed out on any printer (color or B+W). Plan the rooms in your new home long before the first board is cut.

The Dream Builder tool includes grid paper and cutouts of typical furniture pieces. Many items are available in different sizes and styles to approximate your own furniture. The $1/8" = 1'$ size can be used directly with most blueprints to get a quick idea of how your furniture or landscape might come together. The larger $1/4" = 1'$ size works great to lay out an individual room on a single sheet of printer paper.

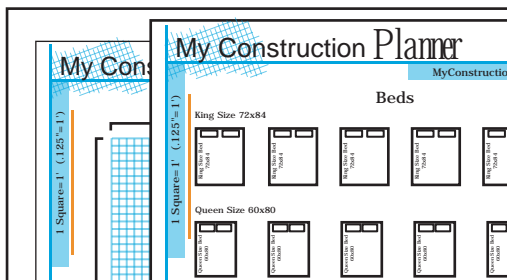

Step 1:
After you have printed out the pages, make sure the grid you are using is the same as the furniture cutouts.

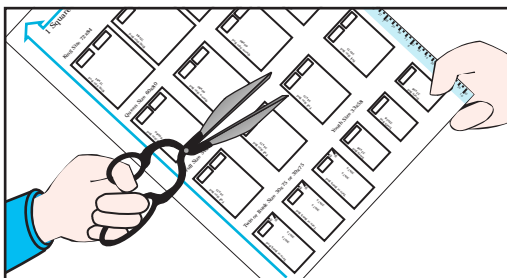

Step 3:
Cut out the furniture you plan to use.

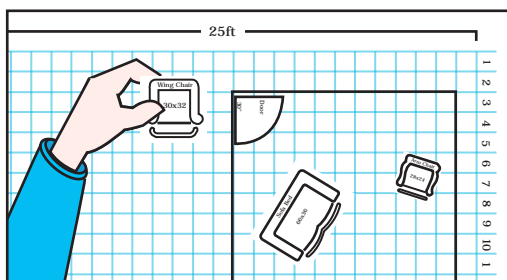

Step 5:
Place your furniture wherever you want. Try different layouts, experiment with different size sizes, have a ball!

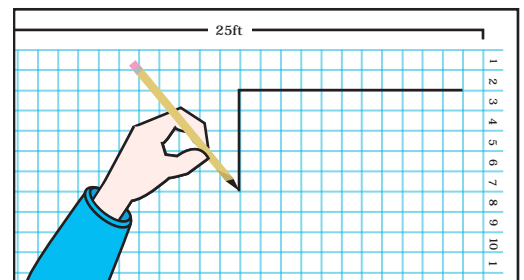

Step 2:
Draw your room on the grid sheet

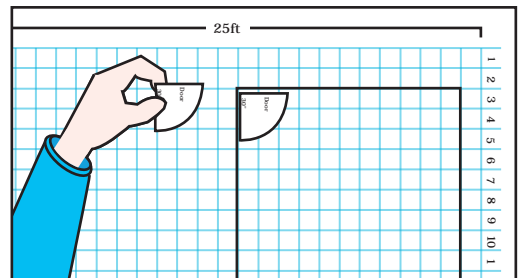

Step 4:
Place the door(s) on the sheet. Make sure they swing the right way to you don't put furniture where a door has to open. You might also want to draw any other features (like windows, fireplace, etc.) on the grid so you know where they are.